

**BROCHURE**



## **TELESPAR® SIGN SUPPORT SYSTEMS**

**Telespar®   Qwik-Punch®   Anchoring   Accessories**

A PART OF



# Telespar®

## Sign Support System

The Telespar® Sign Support System is available with three types of posts: galvanized steel tubing with perforated holes on all four sides, Qwik-Punch® posts, which are made with 1<sup>7</sup>/<sub>16</sub>" knockouts, 1' on the center on all four sides, and the round sign system with socket and wedge. The tubing is produced through a unique manufacturing process that permits tubular sections of different sizes to telescope into the next larger size. It is complemented by a variety of compatible fittings accessories, nuts, bolts, and simple installation tools.

The engineered system of integrated parts enables you to mount signs back-to-back and on adjacent sides. It is designed to make adjustment, reinforcement, and splicing fast and easy. By utilizing a square tube, Telespar® exhibits superior wind load capabilities and torsional stability.

Telespar® is primarily designed for signpost usage but is adaptable for identification signage, parking meter posts, barricades, and numerous other applications.



The Original Telescoping Sign Support System

## The Telespar® Advantage

### Secure Signage

Using the Allied Tube & Conduit® recommended installation method, street signs are securely fastened to posts with rivets, providing greater torsional and wind load stability. Signs mounted via this method are more securely fastened and cannot easily be removed or loosened from their posts due to severe weather conditions. This differs from the bracket system commonly used with U-channel and standard post systems. These systems utilize small set screws that can be damaged or vandalized easily making replacement necessary.

### Easy Installation, Rapid Replacement

Telespar® signposts are installed easily by using either a direct embedded method or breakaway anchor system. Installation can be performed by one-man at ground level, eliminating the need for bucket trucks and similar heavy equipment. Replacement is just as easy, having minimal tool requirements.

### Safety

The Telespar® Sign Support System was the first to be used effectively in a yielding breakaway concept for small sign-support systems. They are FHWA approved and in compliance with AASHTO specifications.

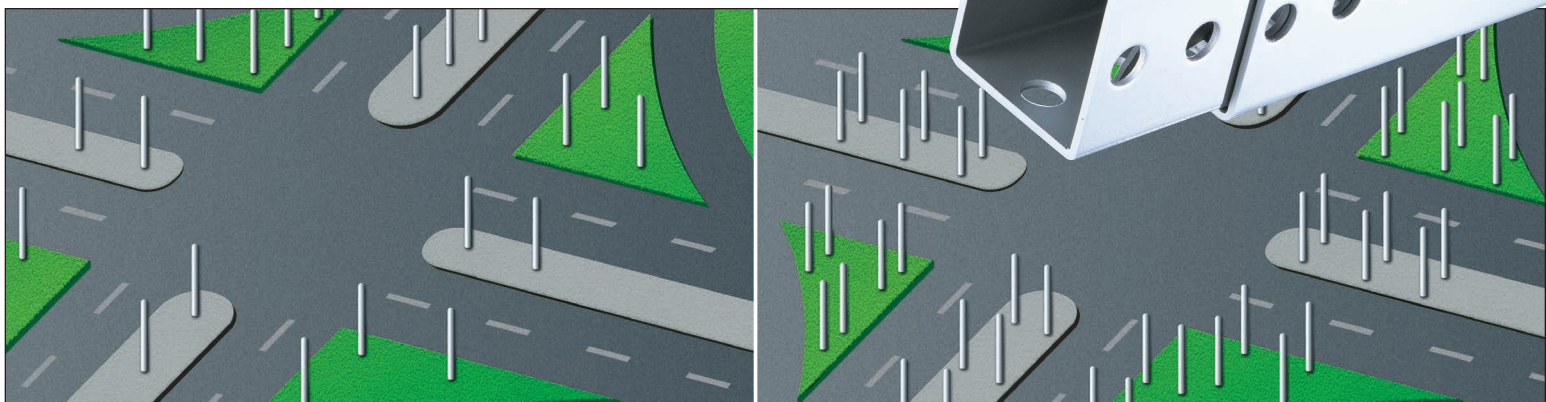

Art from actual INDOT (Indiana Department of Transportation) installation.

### Reduced materials needed per installation

Using Telespar® drastically cuts your material costs. Its greater strength and superior stability allow you to use single post installations instead of U-Channel's double post, cutting your material needs in half!



## Three Types of Posts to Meet Your Needs

One of the keys to the Telespar® Sign Support System's versatility and ease of installation is its three convenient methods for mounting signage.

### Round Sign System

The Telespar® round sign system with socket and wedge provides superior corrosion resistance and strength benefits, demonstrating 50ksi yield strength resulting from the signature inline galvanizing process by Allied Tube & Conduit®. This highly durable product enables you to reduce replacement and repair costs caused by standard wear and tear.

### Posts with Pre-Punched Holes

Telespar® square posts with  $\frac{7}{16}$ " pre-punched holes on 1" centers are corner welded to allow smooth telescoping action.

### Posts with Knockouts

Qwik-Punch® posts are made with  $\frac{7}{16}$ " knockouts, 1" on the center, on all four sides. This feature allows workers in the field to quickly punch holes exactly where they are needed, leaving the balance of the post with a smooth unbroken appearance. These posts offer the same telescoping action and easy installation as standard Telespar® posts.

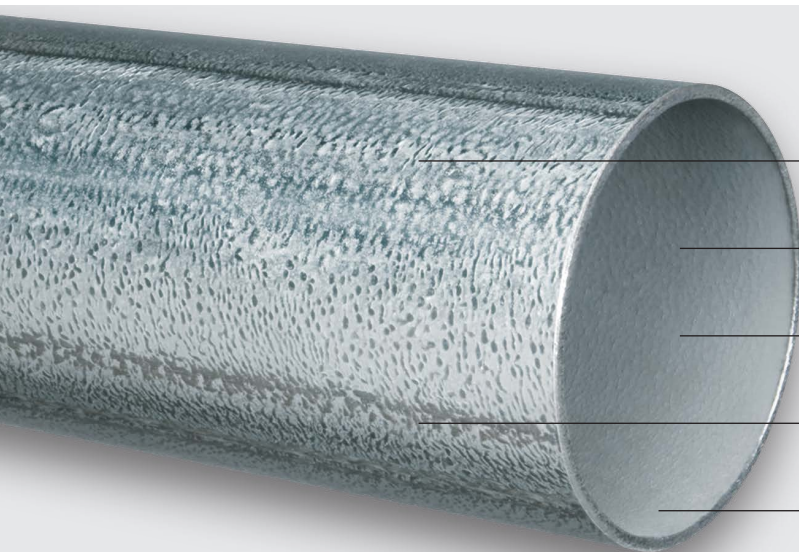

Superior corrosion resistance through the in-line galvanizing process by Allied Tube & Conduit®

Available with pre-punched holes

Easy to re-use

Difficult to vandalize

Socket and wedge system for ease of installation

### Round Sign System Specification

#### ELEMENTS OF SECTION

O.D./Gauge (in)	Wall Thickness (in)	Weight (lb / ft)
2.375 x 10	0.134	3.2101
2.375 x 12	0.109	2.6404
2.375 x 13	0.095	2.3155
2.375 x 14	0.083	2.0336
2.375 x 16	0.065	1.6051
2.875 x 12*	0.109	3.1444

\* Used for Anchors Stocked in 10' and 12' lengths. Other lengths are available upon request.

Easily adjustable via telescoping

Corner welded for smooth  
telescoping action

Square shape allows signs to be  
mounted on all four sides

Square tubing for greater  
wind load capabilities and  
torsional stability

Galvanized steel tubing for  
superior corrosion resistance

**Note: Steel conforms to ASTM A1011 Grade 50; Galvanizing meets ASTM A-653**

$\frac{7}{16}$ " Pre-punched holes

Signs mount with drive rivets for easy  
installation and tamper resistance

Smooth unbroken appearance

Inline zinc coating complies with  
AASHTO M-120

$\frac{7}{16}$ " knockouts on all four sides

FHWA approved breakaway installation

Tube Size (in)	Wall Thickness U.S. Std. Gauge & Inch	Area (sq in)	Wt./Ft. (lb)	I (in <sup>4</sup> )	s (in <sup>3</sup> )	r (in)
1 $\frac{3}{4}$ x 1 $\frac{3}{4}$	14 (0.083)	0.392	1.71	0.201	0.230	0.716
2 x 2	14 (0.083)	0.474	1.99	0.296	0.296	0.790
1 $\frac{1}{2}$ x 1 $\frac{1}{2}$	12 (0.105)	0.380	1.70	0.129	0.172	0.582
1 $\frac{3}{4}$ x 1 $\frac{3}{4}$	12 (0.105)	0.485	2.06	0.231	0.264	0.690
2 x 2	12 (0.105)	0.590	2.42	0.372	0.372	0.794
2 $\frac{1}{4}$ x 2 $\frac{1}{4}$	12 (0.105)	0.695	2.77	0.561	0.499	0.898
2 $\frac{1}{2}$ x 2 $\frac{1}{2}$	12 (0.105)	0.803	3.14	0.804	0.643	1.001
2 $\frac{3}{16}$ x 2 $\frac{3}{16}$	10 (0.135)	0.841	3.43	0.605	0.553	0.848
2 $\frac{1}{2}$ x 2 $\frac{1}{2}$	10 (0.135)	1.010	4.01	0.979	0.783	0.985
1 $\frac{3}{4}$ x 1 $\frac{3}{4}$ QP	14 (0.083)	0.392	1.88	0.201	0.230	0.716
2 x 2 QP	14 (0.083)	0.474	2.16	0.296	0.296	0.790

I = Moment of Inertia

s = Section Modulus

r = Radius of Gyration

# Telespar® Type III Barricade

## Safety and Convenience in One Simple Package

**Requirement:** High-strength yet safe temporary barricade

**Fulfillment:** Telespar® Type III Barricade

### Easy to Use

- Easily stored, transported, and installed
- Legs are detachable
- No welding required

### Barricade Assembly Guidelines

#### Required hardware for each connecting point

- TL 132-Z Shear Pin Barricade Plate (2ea)
- 3/8-16 x 3 grade 8 flange bolt and serrated flange nut (2ea)
- 1/4-20 x 3 grade 2 hex hd shear bolt and hex nut (2ea)

To fulfill your temporary barricade needs, contact Allied Tube & Conduit® at 800-882-5543.

### Safety Features

- FHWA/NCHRP 350 approved
- Temporary, yet crashworthy
- Yielding breakaway
- Minimal damage to impacting vehicle
- Reusable after collision

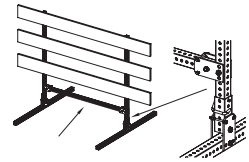
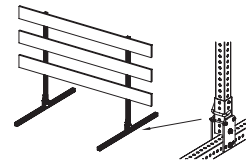
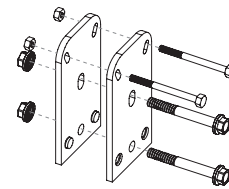



## Anchoring Options

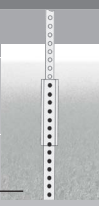

## Installation Guidelines

1. Drive a minimum 30" piece of 12 gauge Telespar® (anchor) into the soil until only 1-2 inches are left exposed. For a 2-piece anchor, use an 18" piece of tubing for a sleeve, one size larger than the anchor. It is advisable to drive the anchor and sleeve together making sure the holes are aligned.
2. Attach the sign to the post at the desired height using drive rivets or bolts.
3. Insert the signpost, which is one size smaller than the anchor, approximately 6-8 inches into the anchor base.
4. Bolt the signpost to the anchor assembly with a corner bolt.
5. When installing in concrete use a pneumatic hammer or concrete drill to break through the surface, the anchor assembly is driven to within 1" of the surface to allow attachment of the signpost. If a flush installation is desired clearance should be recessed on two sides to clear the bolt for signpost connection.
6. To install in asphalt, drive the anchor assembly through the blacktop into the subsoil from ground level. Once the anchor is through the blacktop, use the same instructions as for soil installations.

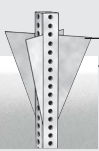
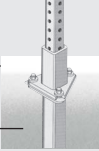
Anchor Type	Description	Unique Feature
<b>Primary</b>  <b>Single Breakaway Anchor</b>  <b>Two-Piece Breakaway Anchor</b>	<p>Can be used by one man working at ground level using manual or power equipment.</p> <p>Can be created by adding an outer sleeve to the original anchor base. This provides a double wall thickness to create a breakaway function.</p>	<p>Minimum installation time</p> <p>Yielding breakaway system</p>
<b>Secondary</b>  <b>Heavy Duty Anchor</b>  <b>Stabilization Anchor Sleeve</b>	<p>For use with larger signposts. The heavy wall eliminates the need for a stiffener sleeve enabling the signpost to break on impact.</p> <p>Attaches to a single anchor with corner bolt then bolted through the post at top of the anchor. Should always be attached to the corner farthest from traffic.</p>	<p>Works well in concrete and areas of high impact</p> <p>For use with soft or drop-off shoulders in loose or sandy soil</p>
 <b>Omni-Directional Anchor</b>  <b>Slip Base Breakaway System</b>	<p>Designed specifically for ease of installation in loose soil conditions enabling the post to perform well when impacted.</p> <p>For use with larger signs when the post is too strong to perform a normal breakaway function. Allows the unit to slip away without creating an unacceptable impact condition.</p>	<p>Easily retrofitted to correct problem installations</p> <p>One of the most economical replacements in the industry</p>

Note: The Telespar® Sign Support System can be directly embedded manually using a drive cap and sledge, with a pneumatic hammer or by means of self-contained power equipment.

## Telespar® Temporary Sign Skids

### Put Your Construction Project on Easy Street

Nobody likes construction delays, the sooner the job is completed, the better it is for everyone. Telespar® temporary sign skids can help you get the job done quicker. This easy to assemble, simple to maneuver system, enables you to set up and reposition your signage quickly, allowing more time for performing the task at hand.

**Requirement:** High-strength yet safe temporary barricade.

**Fulfillment:** Telespar® Type III Barricade

#### Easy to Assemble

- Pre-assembled kits
- Pre-manufactured components
- Eliminates the need to drive posts into the ground

#### Safety

- Crashworthy
- FHWA & NCHRP 350 approved

#### Simple to Maneuver

- Adjustable base
- Telescopic for varied heights
- Detachable leg allows compact stacking
- Reusable



To fulfill your temporary sign skid needs, contact Allied Tube & Conduit® at 800-882-5543.

## Fasteners

### The Corner Bolt

Nobody likes construction delays. The sooner the job is completed, the better it is for everyone. Telespar® temporary sign skids can help you get the job done quicker. This easy to assemble, simple to maneuver system, enables you to set up and reposition your signage quickly, allowing more time for performing the task at hand.

### Drive Rivets

Drive rivets provide the convenience of a one-piece fastener with effective tamper-resistant design and fast installation requiring only a hammer.

### Hex Nuts and Bolts





Standard hex nuts and bolts can also be used to connect components. A special jam nut is available to help form a permanent tamper resistant connection.

### Lock Pins

The lock pin allows for a quick temporary connection between telescoping tube sections. Simply align holes between sections, insert the lock pin and allow it to drop into a locking position.

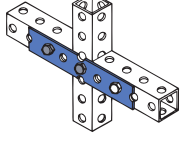
## Fittings

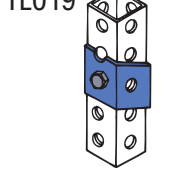
In addition to the above-listed fasteners, the fittings in the chart below also can be used with the Telespar® system

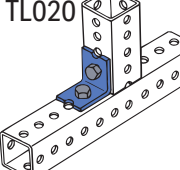
Fittings	Tube Size (in)	Cutting Dimensions* (in)	Fittings	Tube Size	Cutting Dimensions* (in)
 TL015	1½ sq 1¾ sq 2 sq 2¼ sq 2½ sq	Both tubes must be the same size 1⅜ 1⅞ 1⅝ 1⅜ 1⅞	 TL018	1½ sq 1¾ sq 2 sq 2¼ sq 2½ sq	1⅜ 1⅞ 1⅝ 1⅜ 1⅞
 TL016	1½ sq 1¾ sq 2 sq 2¼ sq 2½ sq	Both tubes must be the same size 1⅜ 1⅞ 1⅝ 1⅜ 1⅞	 TL019	1½ sq 1¾ sq 2 sq 2¼ sq 2½ sq	
 TL017	1½ sq 1¾ sq 2 sq 2¼ sq 2½ sq		 TL020	1½ sq 1¾ sq 2 sq 2¼ sq 2½ sq	1 1 1 1 1

\* Distance from edge of tube to center of first hole.



# Telespar®

## Reflective Sleeving

### The Telespar® Reflective Sleeving Advantage

- Low-cost safety enhancement
- Easy-to-install
- Manual on Uniform Traffic Control Devices (MUTCD) compatible
- Comes pre-punched with rivets
- Mitigates tort liability
- Increases visibility for vehicles and pedestrians
- Comes in a variety of color
- Great on highways and rural roads

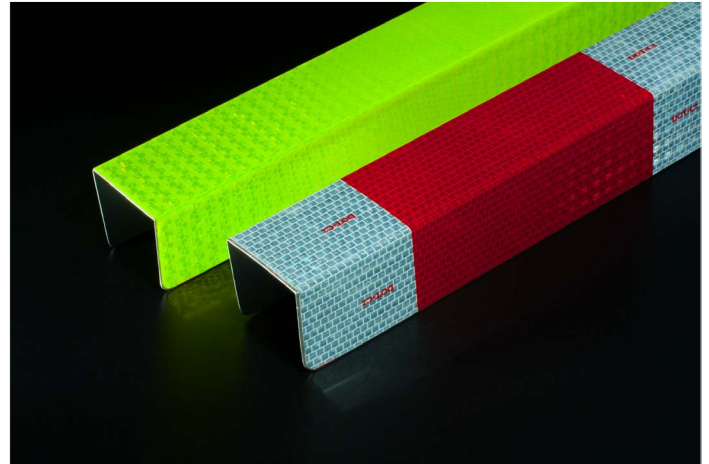

Enhances visibility of older signs

### Colors

- Red and white
- Florescent yellow / green
- Florescent yellow
- Red
- Yellow
- Orange
- White
- Blue

### Sizes

- 2" x 2" x 48"
- 2" x 2" x 72"
- 2.5" x 2.5" x 72"





16100 South Lathrop Ave

Harvey, IL 60426

TPHONE/ 800-889-5543

TOLL-FREE / 800-659-7730

[www.atc-mechanical.com](http://www.atc-mechanical.com)

Want to join a company that helps you build  
the mindset, skill set and tool set for success?  
Visit us at [atkore.com/careers](http://atkore.com/careers)

